

38 923 000 **SOLIDO SET 1**

产品描述

- GD2水箱
- 安装高度为1.13米
- 挂墙用
- 粉末喷涂处理钢架，自立式
- 用于干包层
- 附固定连接
- 可锁定式快速调节
- 固定螺栓长度180/230毫米
- 6/9升GD2水箱
- 出厂调整水量为6升和3升
- 气动冲水阀:双冲,单冲(中断冲水)及不可中断冲水
- 左/右/后进水
- 低噪音(获德国噪音认证)
- 防冷凝
- 现场安装
- 结合配件组合2使用 (38 924 000)

38 923 000 **SOLIDO SET 1**

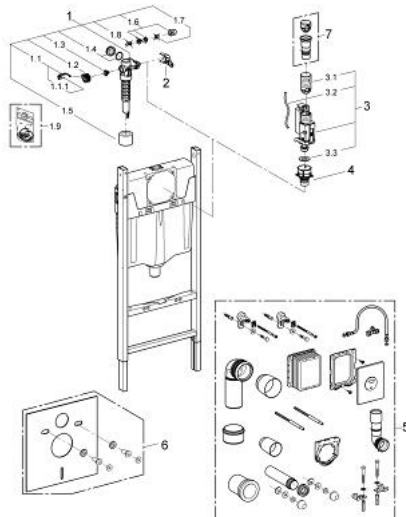

备件, 十一月 2012 – now

- 1: 充水阀 (Order-nr. 37095000)
- 1.1: 把手 (Order-nr. 43734000)
- 1.1.1: 紧固件 (Order-nr. 4377000M)
- 1.2: Valve head (Order-nr. 43536000)
- 1.3: 膜 (Order-nr. 4375800M)
- 1.4: 螺帽 (Order-nr. 43735000)
- 1.5: Valve FLOAT, 5 pcs. (Order-nr. 4379100M)
- 1.6: 密封配套 (Order-nr. 43722000)*
- 2: Support device (Order-nr. 42246000)
- 3: 双重开关阀AV1 (Order-nr. 42320000)
- 3.1: extension for Overflow pipe (Order-nr. 42313000)
- 3.2: Pneumatic hose (Order-nr. 42319000)
- 3.3: 紧固件 (Order-nr. 42310000)
- 4: Valve seat for GD2 (Order-nr. 42315000)
- 5: Set 2 (Order-nr. 38924000)*
- 6: 防噪配套 (Order-nr. 37131000)*
- 7: 4.5 l adapter for GD2 (Order-nr. 42333000)*

* Optional accessories