

31 829 001 高士达L 单孔洗槽盆混合龙头

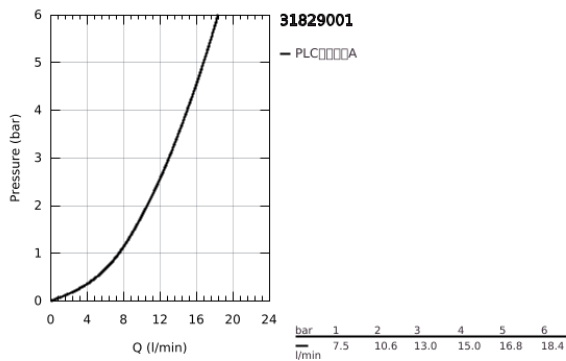

产品描述

- Colour: 镀铬
- 金属把手
- 隔热
- 旋入式
- 耐久阀芯
- 起泡器
- swivel tubular spout, swivel area 360°
- 软管
- maximum flow rate (at 3 bar): 13 l/min
- 通过NF认证

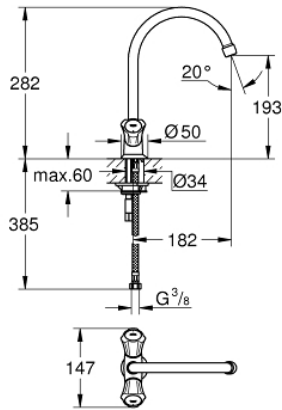

31 829 001 高士达L 单孔洗槽盆混合龙头

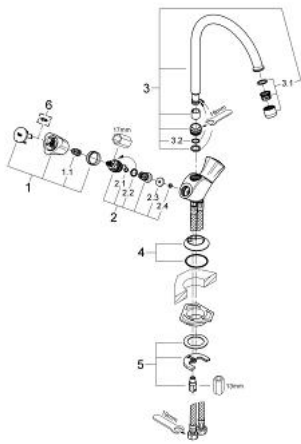

备件, 八月 2011 – now

1: 把手 (Spare part-nr. 45994000)

1.1: 按钮 (Spare part-nr. 0538600M)

2: 阀芯 (Spare part-nr. 07146000)

2.1: Sealing washer $\varnothing 6 \times \varnothing 2$ (Spare part-nr. 0128300M)

2.2: O型圈 $\varnothing 18.2 \times \varnothing 1.7$ (Spare part-nr. 0392400M)

2.3: 紧固件 (Spare part-nr. 0529100M)

3: 出水口 (Spare part-nr. 13213000)

3.1: 起泡器 (Spare part-nr. 13928000)

3.2: O型圈 (Spare part-nr. 0128000M)

4: 法兰盘 (Spare part-nr. 45996000)

5: Shank mounting kit (Spare part-nr. 46249000)

6: Screw for Costa/Avina products (Spare part-nr. 48013000)*

* Optional accessories