

## 31 640 AT0 K400 &#160;&#160;复合花岗岩水槽带滤水板

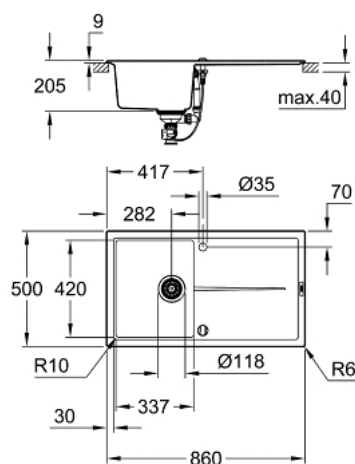

### 产品描述

- Colour: 灰色
- model: K400 50-C 86/50 1.0 rev
- mounting type: top mount
- 材料: 符合花岗岩
- 高仪静流技术
- min. cabinet size: 500 mm
- 尺寸: 860 x 500 毫米
- 1 bowl: 337 x 420 x 205 mm
- outer radius: R6, inner bowl radius: R10
- 高仪快速安装系统
- sink mountable left or right
- 开孔尺寸: 840 x 480 毫米
- drainer: automatic waste fitting
- accessories included: automatic waste fitting with rotary handle, waste kit, basket strainer waste, mounting set
- 可选按压式去水配件 (40 986 SD0)&nbsp;
- amount of fasteners included (top mount): 10
- heat resistant up to 180° C

## 31 640 AT0 K400 &#160;&#160;复合花岗岩水槽带滤水板

备件, 五月 2022 – now

1: 落水塞 (Order-nr. 42588SD1)

2: Siphon (Order-nr. 42617000)

3: Cover element (Order-nr. 42590SD1)

4: 回转接头 (Order-nr. 42587SD0)

