

30 004 000 **K4 单冷龙头**

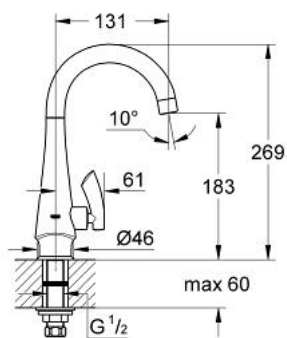

产品描述

- Colour: 镀铬
- 高仪持久镀铬饰面
- 陶瓷阀芯1/2", 90°
- 高仪真钢 产品材料 (不锈钢本体)
- 旋转出水
- 起泡器
- 软管
- projection 131 mm
- an adaptor to change the connection from American to European standards is included.
- coordinated K4 design



30 004 000 **K4 单冷龙头**

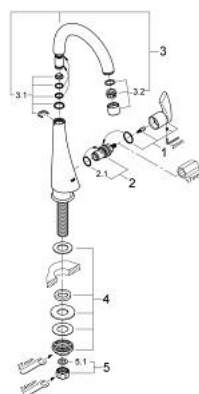

备件, 十一月 2004 – now

- 1: 把手 (Order-nr. 45394000)
- 2: 陶瓷阀芯 (Order-nr. 45882000)
- 3: 出水口 (Order-nr. 13202000)
- 3.1: 出水口连接配套 (Order-nr. 45399000)
- 3.2: 起泡器 (Order-nr. 13935000)
- 4: Shank mounting kit (Order-nr. 45004000)
- 5: Coupling nut 1/2" (Order-nr. 1290100M)
- 5.1: 连接垫圈 (Order-nr. 0138900M)