

## 26 016 001 高士达L 实心面盆龙头

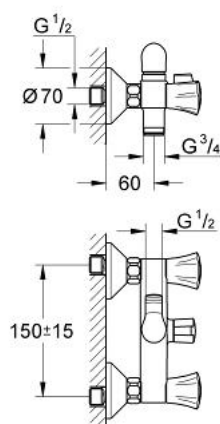

### 产品描述

- Colour: 镀铬
- 墙面安装
- 金属把手
- 隔热
- 旋入式
- 耐久阀芯
- 浴缸/淋浴分水
- S弯
- 弯头套管 3/4" x 1/2" (12 001)
- 高仪星闪镀铬饰面

## 26 016 001 高士达L 实心面盆龙头

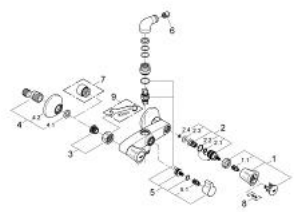

备件, 十月 2009 – now

- 1: 把手 (Order-nr. 45994000)
- 1.1: 按钮 (Order-nr. 0538600M)
- 2: 阀芯 (Order-nr. 07146000)
- 2.1: Sealing washer Ø 6 x Ø 2 (Order-nr. 0128300M)
- 2.2: O型圈 Ø 18.2 x Ø 1.7 (Order-nr. 0392400M)
- 2.3: 紧固件 (Order-nr. 0529100M)
- 3: 埋头螺母 (Order-nr. 45044000)
- 4: S弯 (Order-nr. 12075000)
- 4.1: 紧固件 (Order-nr. 0138600M)
- 4.2: 法兰盘 (Order-nr. 0221000M)
- 5: Repl.kit f.rotary valve (Order-nr. 48006000)
- 5.1: 按钮 (Order-nr. 0538600M)
- 6: 防回流阀 (Order-nr. 08565000)
- 7: 延长配件 3/4 (Order-nr. 0713000M)\*
- 8: Screw for Costa/Avina products (Order-nr. 48013000)\*
- 9: Special spanner (Order-nr. 19377000)\*

\* Optional accessories