

26 009 001 高士达L 淋浴龙头 1/2

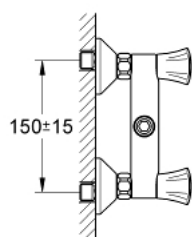

产品描述

- Colour: 镀铬
- 墙面安装
- 隔热
- 金属把手
- 旋入式
- 耐久阀芯
- 淋浴顶部出水口3/4"
- S弯
- 高仪持久镀铬饰面

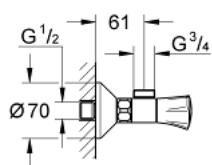
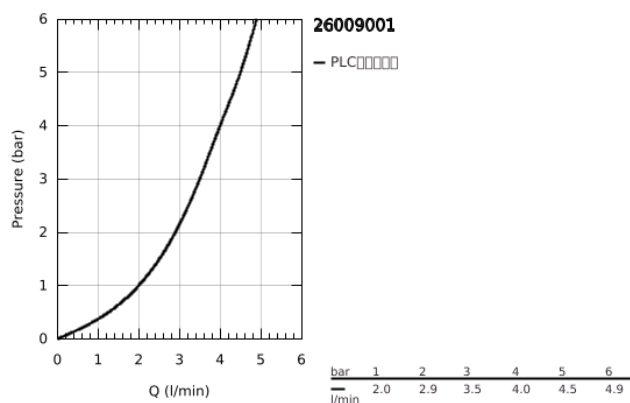

26 009 001 高士达L 淋浴龙头 1/2

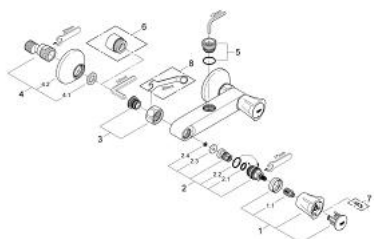

备件, 六月 2007 – now

1: 把手 (Order-nr. 45994000)

1.1: 按钮 (Order-nr. 0538600M)

2: 阀芯 (Order-nr. 07146000)

2.1: Sealing washer Ø 6 x Ø 2 (Order-nr. 0128300M)

2.2: O型圈 Ø 18.2 x Ø 1.7 (Order-nr. 0392400M)

2.3: 紧固件 (Order-nr. 0529100M)

3: 埋头螺母 (Order-nr. 45044000)

4: S弯 (Order-nr. 12075000)

4.1: 紧固件 (Order-nr. 0138600M)

4.2: 法兰盘 (Order-nr. 0221000M)

5: 螺纹接套 (Order-nr. 45332000)

6: 延长配件 3/4 (Order-nr. 0713000M)*

7: Screw for Costa/Avina products (Order-nr. 48013000)*

8: Special spanner (Order-nr. 19377000)*

* Optional accessories