

## 24 020 ZB0 赛柏莉 三孔妇洗盆混合龙头



### 产品描述

- Colour: 古铜色
- 无把手
- 边缘冲水/妇洗盆花洒
- 带防真空装置
- 抗压软管
- 用于赛柏莉十字把手和一字把手18 731 / 18 732
- 高仪持久镀铬饰面

## 24 020 ZB0 赛柏莉 三孔妇洗盆混合龙头

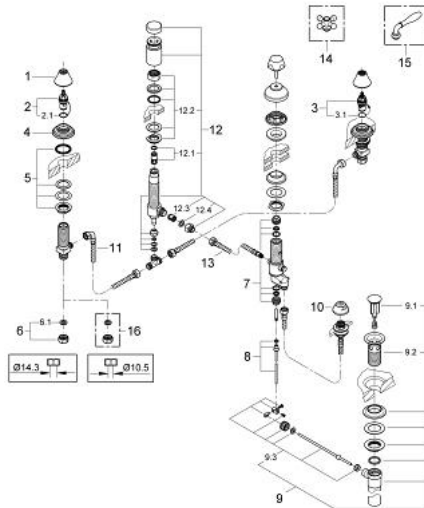

备件, 十二月 2013 – now

- 1: 面板 (Order-nr. 45907ZB0)
- 2: 陶瓷阀芯 (Order-nr. 45882000)
- 2.1: O型圈 Ø 18.2 x Ø 1.7 (Order-nr. 0392400M)
- 3: 陶瓷阀芯 (Order-nr. 45883000)
- 3.1: O型圈 Ø 18.2 x Ø 1.7 (Order-nr. 0392400M)
- 4: 法兰盘 (Order-nr. 45906ZB0)
- 5: Shank fastening assembly M28 x 1.5 (Order-nr. 45025000)
- 6: Coupling nut 1/2" x 14.5 mm (Order-nr. 1290200M)
- 6.1: 连接垫圈 (Order-nr. 0138900M)
- 7: 密封工具 (Order-nr. 45027000)
- 8: Swivel vertical pop-up rod (Order-nr. 45646000)
- 9: 落水

(Order-nr. 28957ZB0)

- 9.1: 落水塞 (Order-nr. 45324ZB0)
- 9.2: 罩 (Order-nr. 01153ZB0)
- 9.3: 球头杆 (Order-nr. 45264000)
- 10: 花洒头 (Order-nr. 02664ZB0)
- 11: 软管 (Order-nr. 45704000)
- 12: 真空断路器 (Order-nr. 45852ZB0)
- 12.1: Shank mounting kit (Order-nr. 45855000)
- 12.2: 防回流阀 (Order-nr. 08565000)
- 12.3: 连接垫圈 (Order-nr. 0138900M)
- 13: 软管 (Order-nr. 46254000)
- 14: 十字把手 (Order-nr. 18731ZB0)\*
- 15: 一字把手 (Order-nr. 18732ZB0)\*
- 16: Coupling nut 1/2" (Order-nr. 1290100M)\*

\* Optional accessories