

24 019 ZB0 日内瓦 三孔妇洗盆混合龙头



产品描述

- Colour: 古铜色
- 无把手
- 边缘冲水/妇洗盆花洒
- 带防真空装置
- 抗压软管
- 用于日内瓦十字把手和一字把手18 733 / 18 734
- 高仪持久镀铬饰面

24 019 ZB0 日内瓦 三孔妇洗盆混合龙头

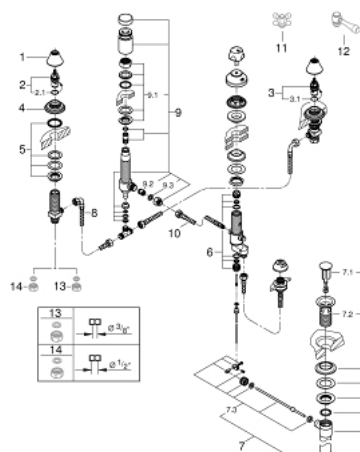

备件, 八月 2016 – now

- 1: 面板 (Order-nr. 45907ZB0)
- 2: 陶瓷阀芯 (Order-nr. 45882000)
- 2.1: O型圈 Ø 18.2 x Ø 1.7 (Order-nr. 0392400M)
- 3: 陶瓷阀芯 (Order-nr. 45883000)
- 3.1: O型圈 Ø 18.2 x Ø 1.7 (Order-nr. 0392400M)
- 4: 法兰盘 (Order-nr. 45906ZB0)
- 5: Shank fastening assembly M28 x 1.5 (Order-nr. 45025000)
- 6: 密封工具 (Order-nr. 45027000)
- 7: 落水

(Order-nr. 28957ZB0)

- 7.1: 落水塞 (Order-nr. 45324ZB0)
- 7.2: 罩 (Order-nr. 01153ZB0)
- 7.3: 球头杆 (Order-nr. 45264000)
- 8: 软管 (Order-nr. 45704000)
- 9: 真空断路器 (Order-nr. 45852ZB0)
- 9.1: Shank mounting kit (Order-nr. 45855000)
- 9.2: 防回流阀 (Order-nr. 08565000)
- 9.3: 连接垫圈 (Order-nr. 0138900M)
- 10: 软管 (Order-nr. 46254000)
- 11: 十字把手 (Order-nr. 18733ZB0)*
- 12: 一字把手 (Order-nr. 18734ZB0)*
- 13: Coupling nut 1/2" (Order-nr. 1290100M)*
- 14: Coupling nut 1/2" x 14.5 mm (Order-nr. 1290200M)*

* Optional accessories