

20 801 ZB0 日内瓦 三孔盥洗盆混合龙头



产品描述

- Colour: 古铜色
- 无把手
- 高出水带起泡器
- 90度陶瓷阀芯
- 1 1/4" 提拉杆落水
- 接头带10.5毫米孔
- 抗压软管
- 用于日内瓦十字把手和一字把手18 733 / 18 734
- 高仪持久镀铬饰面

20 801 ZB0 日内瓦 三孔盥洗盆混合龙头

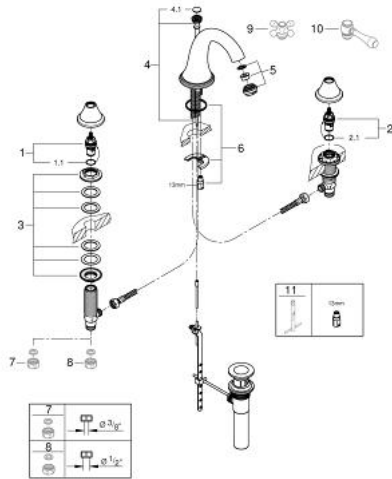

备件, 七月 2016 – now

- 1: 陶瓷阀芯 (Spare part-nr. 45882000)
- 1.1: O型圈 Ø 18.2 x Ø 1.7 (Spare part-nr. 0392400M)
- 2: 陶瓷阀芯 (Spare part-nr. 45883000)
- 2.1: O型圈 Ø 18.2 x Ø 1.7 (Spare part-nr. 0392400M)
- 3: Shank fastening assembly M28 x 1.5 (Spare part-nr. 45025000)
- 4: 落水 (Spare part-nr. 45791ZB0)
- 4.10: Marking piece (Spare part-nr. 45763L00)
- 5: 流量限制器 (Spare part-nr. 13931ZB0)
- 6: Shank mounting kit (Spare part-nr. 46249000)
- 7: 球头杆 (Spare part-nr. 48332000)
- 9: Coupling nut 1/2" (Spare part-nr. 1290100M)*
- 10: Coupling nut 1/2" x 14.5 mm (Spare part-nr. 1290200M)*
- 11: 扳手 (Spare part-nr. 19017000)*
- 12: 十字把手 (Spare part-nr. 18733ZB0)*
- 13: 一字把手 (Spare part-nr. 18734ZB0)*

* Optional accessories