

20 800 00A 赛柏莉 三孔盥洗盆混合龙头

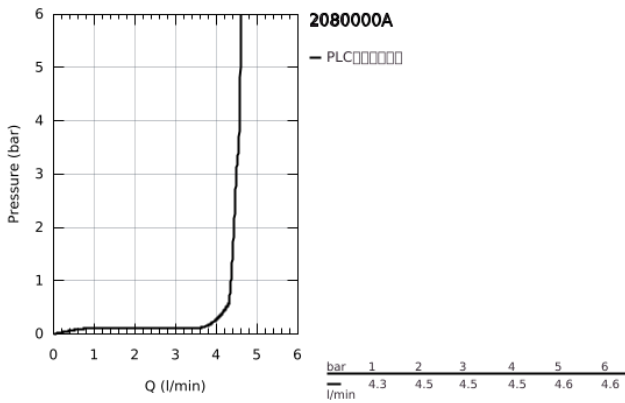

产品描述

- Colour: 镀铬
- 无把手
- 出水口带起泡器
- 90度陶瓷阀芯
- 1 1/4" 提拉杆落水
- 抗压软管
- 用于赛柏莉十字把手和一字把手18 731 / 18 732
- 高仪持久镀铬饰面
- 最大流速: 1.2加仑/分钟 (4.5升/分钟)

20 800 00A 赛柏莉 三孔盥洗盆混合龙头

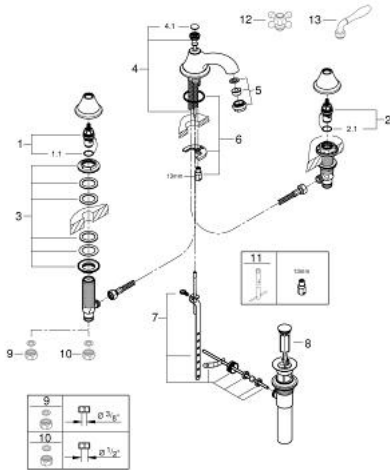

备件, 六月 2015 – now

- 1: 陶瓷阀芯 (Spare part-nr. 45882000)
- 1.1: O型圈 Ø 18.2 x Ø 1.7 (Spare part-nr. 0392400M)
- 2: 陶瓷阀芯 (Spare part-nr. 45883000)
- 2.1: O型圈 Ø 18.2 x Ø 1.7 (Spare part-nr. 0392400M)
- 3: Shank fastening assembly M28 x 1.5 (Spare part-nr. 45025000)
- 4: 落水 (Spare part-nr. 45766000)
- 4.1: Marking piece (Spare part-nr. 45763L00)
- 5: 流量限制器 (Spare part-nr. 13931000)
- 6: Shank mounting kit (Spare part-nr. 46249000)
- 7: 球头杆 (Spare part-nr. 48332000)
- 8: 落水塞 (Spare part-nr. 48331000)
- 9: Coupling nut 1/2" (Spare part-nr. 1290100M)*
- 10: Coupling nut 1/2" x 14.5 mm (Spare part-nr. 1290200M)*
- 11: 扳手 (Spare part-nr. 19017000)*
- 12: 十字把手 (Spare part-nr. 18731000)*
- 13: 一字把手 (Spare part-nr. 18732000)*

* Optional accessories