

## 20 122 BE0 赛柏莉 &#160;三孔盥洗盆混合龙头



### 产品描述

- Colour: 抛光镍
- 无把手
- 出水口带起泡器
- 90度陶瓷阀芯
- 1 1/4" 提拉杆落水
- 抗压软管
- 高仪持久镀铬饰面
- 用于赛柏莉十字把手和一字把手18 731 / 18 732

## 20 122 BE0 赛柏莉 &#160;三孔盥洗盆混合龙头

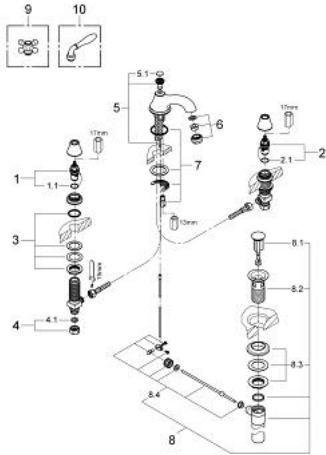

备件, 七月 2008 – now

- 1: 陶瓷阀芯 (Spare part-nr. 45882000)
  - 1.1: O型圈 Ø 18.2 x Ø 1.7 (Spare part-nr. 0392400M)
  - 2: 陶瓷阀芯 (Spare part-nr. 45883000)
  - 2.1: O型圈 Ø 18.2 x Ø 1.7 (Spare part-nr. 0392400M)
  - 3: Shank fastening assembly M28 x 1.5 (Spare part-nr. 45025000)
  - 4: Coupling nut 1/2" x 14.5 mm (Spare part-nr. 1290200M)
  - 4.1: 连接垫圈 (Spare part-nr. 0138900M)
  - 5: 落水 (Spare part-nr. 45766BE0)
  - 5.1: Marking piece (Spare part-nr. 45763L00)
  - 6: 流量限制器 (Spare part-nr. 13931BE0)
  - 7: Shank mounting kit (Spare part-nr. 46249000)
  - 8: 落水 (Spare part-nr. 28957BE0)
  - 8.1: 落水塞 (Spare part-nr. 45324BE0)
  - 8.2: 罩 (Spare part-nr. 01153BE0)
  - 8.3: 球头杆 (Spare part-nr. 45264000)
  - 9: 十字把手 (Spare part-nr. 18731BE0)\*
  - 10: 一字把手 (Spare part-nr. 18732BE0)\*
- \* Optional accessories