

20 121 EN0 三孔盥洗盆混合龙头



产品描述

- Colour: 拉丝镍
- 无把手
- 出水口带起泡器
- 90度陶瓷阀芯
- 1 1/4" 提拉杆落水
- 抗压软管
- 高仪持久表面

20 121 EN0 三孔盥洗盆混合龙头

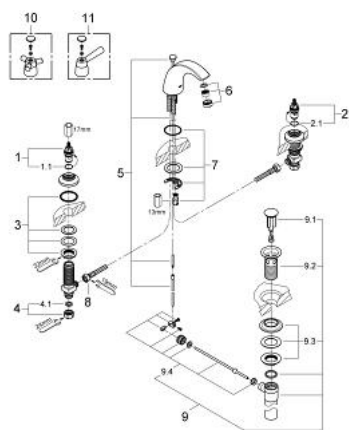

备件, 四月 2008 – now

- 1: 陶瓷阀芯 (Order-nr. 45882000)
- 1.1: O型圈 Ø 18.2 x Ø 1.7 (Order-nr. 0392400M)
- 2: 陶瓷阀芯 (Order-nr. 45883000)
- 2.1: O型圈 Ø 18.2 x Ø 1.7 (Order-nr. 0392400M)
- 3: Shank fastening assembly M28 x 1.5 (Order-nr. 45025000)
- 4: Coupling nut 1/2" x 14.5 mm (Order-nr. 1290200M)
- 4.1: 连接垫圈 (Order-nr. 0138900M)
- 5: 落水 (Order-nr. 48002EN0)
- 6: 流量限制器 (Order-nr. 13955EN0)
- 7: Shank mounting kit (Order-nr. 46249000)
- 8: 软管 (Order-nr. 46255000)
- 9: 落水
- (Order-nr. 28957EN0)
- 9.1: 落水塞 (Order-nr. 45324EN0)
- 9.2: 罩 (Order-nr. 01153EN0)
- 9.3: 球头杆 (Order-nr. 45264000)
- 10: 雅顿十字把手 (Order-nr. 18084EN0)*
- 11: 雅顿一字把手
- (Order-nr. 18083EN0)*
- * Optional accessories