

26 376 000 瑞雨F40 预埋件

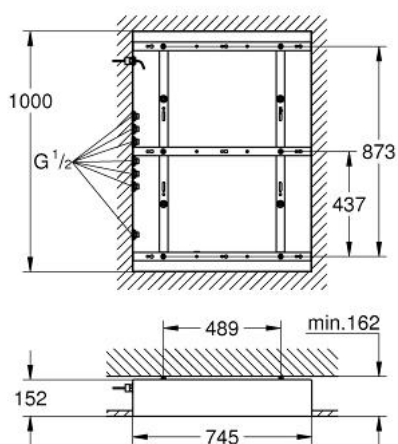

产品描述

- Colour: 镀铬
- 与瑞雨F系列40"水之交响头顶花洒结合使用
- 1000 mm x 745 mm x 152 mm
- 最小安装深度: 167 毫米
- 水路: 黄铜
- 1/2" 连接
- The ceiling construction must be appropriate for the static requirement of the product (total product weight > 70 kg). Ceiling shower has to be controlled by 7 outlets + 1 hand shower outlet and the performance of the waste must be of sufficient size (> 100 l/min). For detailed planning please see separate planning & installation guide before start.
- Note: mounting pattern for Grohtherm F THM complete kit (34 634 000) included