

- Colour: 镀铬
- 90度陶瓷阀芯
- 高仪星闪镀铬饰面
- 高仪快速安装系统
- 1 1/4" 提拉杆落水
- 抗压软管

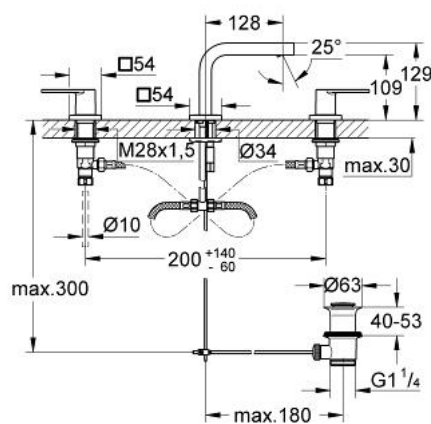

20 306 000 科迪亚 挂墙式三孔面盆龙头170MM

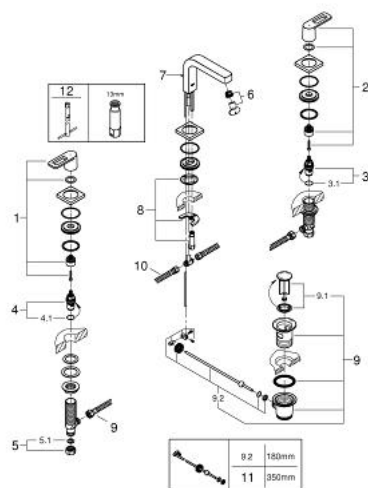

备件, 七月 2015 – now

- 1: 科迪亚把手 (热) (Order-nr. 48111000)
- 2: 科迪亚把手 (冷) (Order-nr. 48112000)
- 3: 陶瓷阀芯 (Order-nr. 45883000)
- 3.1: O型圈 Ø 18.2 x Ø 1.7 (Order-nr. 0392400M)
- 4: 陶瓷阀芯 (Order-nr. 45882000)
- 4.1: O型圈 Ø 18.2 x Ø 1.7 (Order-nr. 0392400M)
- 5: Coupling nut 1/2" (Order-nr. 1290100M)
- 5.1: 连接垫圈 (Order-nr. 0138900M)
- 6: 起泡器 (Order-nr. 13994000)
- 7: 落水 (Order-nr. 65196000)
- 8: Shank mounting kit (Order-nr. 46671000)
- 9: 落水配套 (Order-nr. 28910000)
- 9.1: 落水塞 (Order-nr. 07182000)
- 9.2: 球头杆 (Order-nr. 07052000)
- 10: 软管 (Order-nr. 45442000)
- 11: 球头杆 (Order-nr. 07341000)*
- 12: 扳手 (Order-nr. 19017000)*

* Optional accessories